

# DAFA RooFoil 230 MH Plus™



## Warranty.

DAFA offers a function and product warranty for 10 years on all products associated with DAFA AirVent System.

DAFA RooFoil 230 MH Plus is part of the DAFA AirVent System and is a powerful vapor-permeable membrane used as roof underlay. The membrane is fitted with integrated self-adhesive borders on the front and back with overlap.

### Application

As roof underlay, DAFA RooFoil 230 MH Plus is used as self-supporting material in both ventilated and unventilated roof structures with a pitch above 15°. The integrated self-adhesive borders at the overlap ensure quick installation.

### Material

DAFA RooFoil 230 MH Plus is a 3-layer membrane manufactured from a combination of PP material and foil with high tear strength. The membrane is vapor-permeable with a Sd value of approximately 0.02 m. The integrated self-adhesive borders at the overlap on both front and back with high tack value ensure permanent adhesion.

The moisture-absorbing felt on the back can absorb and temporarily store as much as 720g of condensed water per m<sup>2</sup>. It ensures efficient drying and contributes to fewer condensation and moisture problems in the cold season.

### Quality assurance

DAFA RooFoil 230 MH Plus is CE-marked according to EU standard EN 13859-1.

### Environment

DAFA RooFoil 230 MH Plus is listed in the database for building products that can be used in Nordic Swan Ecolabelled buildings.

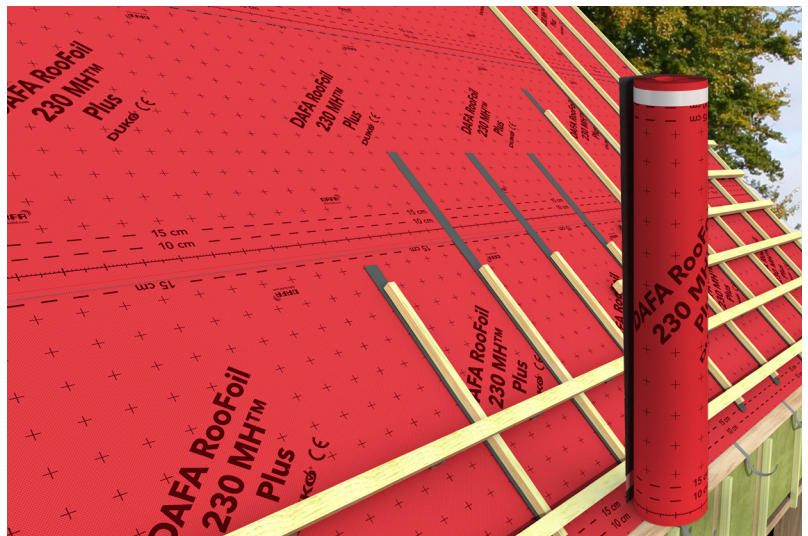

### Dimensions and weight

DAFA RooFoil 230 MH Plus weighs 230 g/m<sup>2</sup>, which makes it easy to roll out. The rollers contain 50 m, which means that the number of joints can be reduced considerably.

#### Technical specifications

Name	Method	Unit	Result
Roll length	EN 1848-2	m	≥50
Roll width	EN 1848-2	m	1,5 +1,0 /0,4%
Weight (including adhesive)	EN 1849-2	g/m <sup>2</sup>	240
Fire classification	EN 13501-1	Class	E
Tear strength lengthways/ crosswise	EN 12310-1	N	340 / 300 ± 15N
Elongation at break lengthway/crosswise	EN 12311-1	%	55 / 70 ± 15%
Tensile strength lengthway/ crosswise	EN 12311-1	N / 50 mm	680 / 600 ± 20N/50 mm
S <sub>d</sub> value	EN 1931 DIN EN ISO 12572	Sd m	≥ 0.02
Water tightness	EN 1928	Class	W1
Temperature resistance	En 1109	°C	-40 to +100
Exposure time			8 weeks max
DAFA item no			620031982
EAN nummer			5705636451855

#### LCA calculation

Product	Unit	GWP-total (A1-A3)	GWP-total (The whole system)
DAFA RooFoil 230 MH Plus	kg CO <sub>2</sub> eq./m <sup>2</sup>	0,994	1,176

NEW



Download EPD for DAFA RooFoil 230 MH Plus here:  
[www.dafa-build.com/en/epd](http://www.dafa-build.com/en/epd)  
or scan the QR code

# DAFA RooFoil 230 MH Plus™

## Roof underlay structures

DAFA RooFoil 230 MH Plus is vapor-permeable and as such ideal as roof underlay in both ventilated and unventilated roof structures.

DAFA RooFoil 230 MH Plus as self-supporting roof underlay in ventilated structure

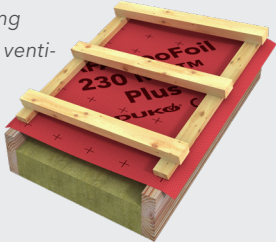

DAFA RooFoil 230 MH Plus as self-supporting, vapor-permeable roof underlay in unventilated structure

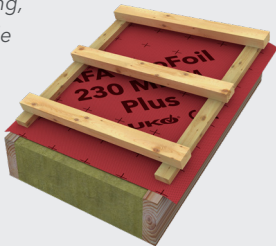

DAFA RooFoil 230 MH Plus as sealed layer on solid roof underlay in ventilated structure

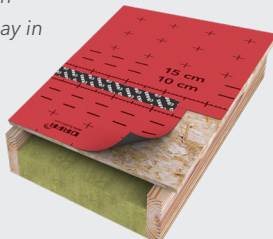

## Installation

DAFA RooFoil 230 MH Plus can be installed in damp weather but must not be installed in freezing conditions. Maximum exposure time is eight weeks. As DAFA RooFoil 230 MH Plus is permeable, it can be insulated to the fabric. DAFA RooFoil 230 MH Plus is rolled out with the product name facing outward and a minimum overlap of 150 mm. Joints are taped with DAFA UV tape for a complete seal. DAFA RooFoil 230 MH Plus is not step-proof or fall-proof.

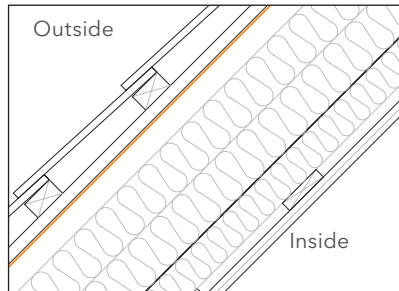

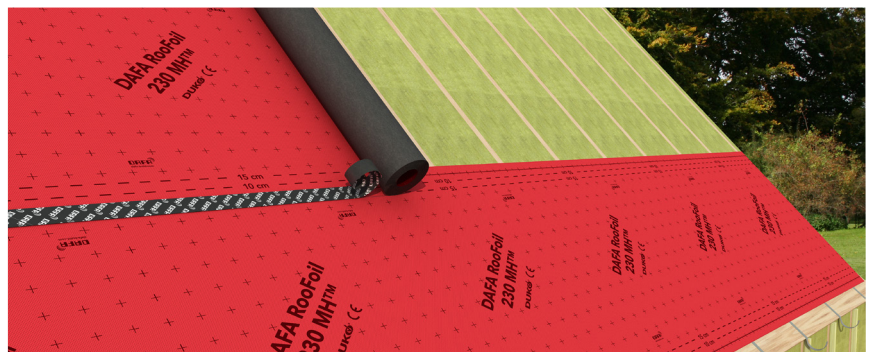

DAFA RooFoil 230 MH Plus used as roof underlay with ventilation between the insulation and the roof underlay.

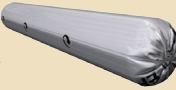

DAFA RooFoil 230 MH Plus is installed with an overlap of minimum 150 mm. Self-adhesive borders in both sides ensure optimal adhesion.

## Recommended accessories from DAFA

			
DAFA UV tape	DAFA universal outdoor adhesive	DAFA UV cable collar	DAFA UV pipe collar
<i>Ideal for overlap taping roofing and wind barriers.</i>	<i>Specially made adhesive with excellent adhesive properties.</i>	<i>Fully sealed conduits for cables or electrical boxes.</i>	<i>Fully sealed conduits for round or rectangular pipes.</i>

DAFA AirVent System comprises a large range of accessories for DAFA RooFoil 230 MH Plus which are special products that make difficult details easier and ensure a fully sealed installation. Read more at [www.dafa-build.com/en/airvent](http://www.dafa-build.com/en/airvent)

